

Cleaning and removing blade set

- Removing blade set

To remove blade set, first make sure your clipper motor is switched 'OFF', then push down with one or both thumbs and slide blade off blade hinge.



- Clean blades with small brush.

(Disassembling will cause malfunction. Do not attempt to disassemble.)

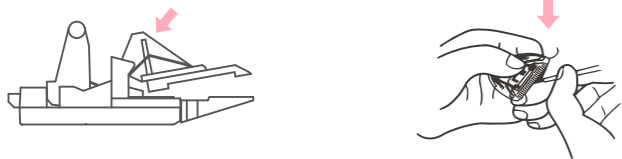

- After cleaning, apply tiny drop lubricant oil on the high light area of the blades, which shown on figure 1 (Must hear a "click" sound and then into alignment with the slot in order to determine exactly loaded.)

NOTE: Please put 1.9mm tip in position before loading.

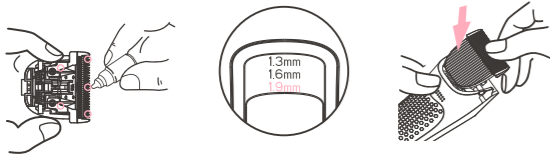

FIGURE 1

LEVER ADJUSTMENT

BLADE INSTALLATION

Warranty card

THE FOLLOWING PRODUCTS GUARANTEE

- This product under-went strict quality control and inspection during the manufacturing process.
- Product has a 1 year warranty while the battery only has 6 months warranty. Improper use will automatically void warranty.
- Warranty will be voided if the following occurs:
 - Failure caused by improper use
 - Attempting to repair the clipper yourself.
 - Dropping clipper
 - Power failures caused by short circuit
 - Non-compliance with the specification precautions caused by fault
- It is mandatory that proof of purchase and warranty card are included with your defected item. If it is not, the warranty will automatically be voided.
- This product repair parts retention period of 3 years

WARRANTY CARD

Purchase Date: _____

Point of Sale Phone: _____

Sales point address: _____



HUSH
PROFESSIONAL

Sales Representative: EAGLE FORTRESS INTERNATIONAL CORPORATION LIMITED

Add: Rm.3,16/F, Wah Sang Industrial Bldg., 14-48 Wong Chuk Yeung Street, Fo Tan, Shatin, N.T. Hong Kong

Service Hotline: 852 6856 0200

Fax: 852 2409 9997

Website: www.eaglefortress.com

HUSH
PROFESSIONAL

Model: 1060-EXT

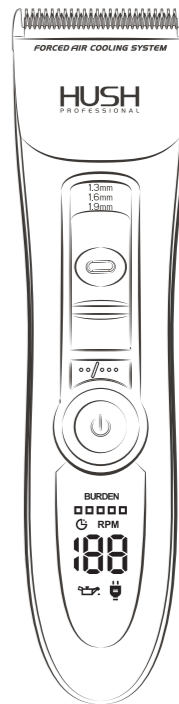

PATENTS:

201730157873.8

201520017469.6

201520016129.1

Rev. 1.1

This product is designed to trim hair and should not be used to trim artificial hair or used for other purposes. The company will not be held responsible for injuries or malfunctions that are caused by improper use.

Safety Precautions

Keep away from children

This appliance contains sharp blades which can cut and small attachments that are considered a choking hazard. Keep appliance in a safe and unreachable area away from children.

Proper and safe usage

1. Be sure to unplug the power cord/adaptor before cleaning the appliance.
2. When cleaning the head of the unit, completely remove the head and clean with the cleaning brush provided.
3. When cleaning the appliance, do not clean near water or any containers containing liquid chemicals.
4. If the appliance will not be in use, unplug and store in a safe place after cleaning.
5. Never operate this appliance if the cord or plug is damaged, if it is not working properly, it has been dropped or damaged, or dropped into water. Return the appliance to service department for examination and repair.
6. Please do not try to dismantle the appliance, if unit needs to be repaired send to the designated service point.
7. Make sure that the correct voltage is being used before putting the unit to charge (AC 100V-240V 50 / 60Hz).

Malfunction possibilities

1. This appliance contains batteries that are non-replaceable. Do not disassemble, puncture battery pack and attempt to replace battery. Otherwise, it may cause the risk of burns, fire, electric shock.
2. Do not disassemble the blades.
3. Do not operate the unit below 140 °F (-10°C) or over 104 °F (40°C), it may damage the battery.

How to avoid damage

1. Please use the original parts, do not self-sharpen the blade;
2. Please do not use this appliance to prune other items, only for pruning hair;
3. For the purposes of recharging the battery, only use the detachable supply unit provided with this appliance.

Product Overview

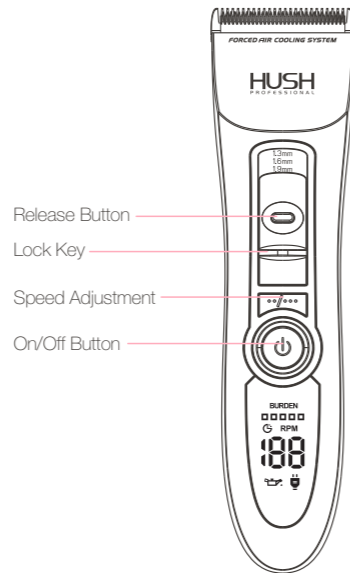

Lubricating oil bottle



Cleaning Brush



3-6 mm Guard X 1



9-12 mm Guard X 1

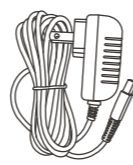

Charger Adapter

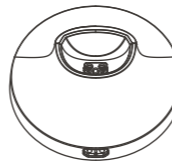

Charging Base X 1

Product Specifications

Model: 1060-EXT			
Item	Specifications	Item	Specifications
Charger	Input AC100V-240V 50/60Hz	Battery Type	Lithium-ion rechargeable battery
	Output DC3.5V 1000mA	Charging Time	About 3 hours
Battery	3.7V 2600mAh	Fully Charged	About 5 hours

LED Screen Function Description

The LED screen display features all control functions shown below:

Motor Speed (Rotation per Minute)

This model with either the cord or the battery has 5 speed settings ranging from 5,000 RPM to 7,500 RPM.

Smart Clip Sensor

Sense blade resistance and revs up the motor speed.

Timing

Time display shows minute usage per RPM.

It still shows 199 Min when the battery remaining time > 199 Min.

Level of Blade Resistance	□□□□	□□□□	□□□□	□□□□	□□□□
Speed (RPM)	5000RPM	5500RPM	6000RPM	6500RPM	7000RPM
Operable Time	260Min	245Min	230Min	215Min	200Min

Lubing

The low oil indicator will blink indicating that the unit needs to be oiled after 60 min of appearing on the screen.

Charging Tips

When the unit has about 10 min left of power, the clipper will remind you to charge by making 3 ticking sounds.

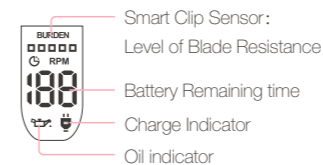

Smart Clip Sensor:
Level of Blade Resistance
Battery Remaining time
Charge Indicator
Oil indicator

Length Adjustments

The clipper is equipped with four adjustment settings for a variety of cuts starting at 1.0mm \ 1.3mm \ 1.6mm then 1.9mm.

The user is able to adjust accordingly

- ◆ When moving upwards for a short hair length, use your thumb to push the Lock Key directly to the corresponding adjustment.
- ◆ When moving downwards for a long hair length, press the Release Button to push down to the corresponding adjustment

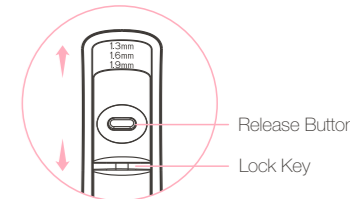

NOTE: When moving upwards, please do not press the Release Button, in order to avoid the Lever can not lock.

Clipper guards and uses

The guards are used to determine how much of the hair will be trimmed off. The sizes included are 3mm, 6mm, 9mm, 12mm.

Guard Installation:

Fasten guard by sliding it in a downward position and then push inward. When secured the guards will not fall out during use.

Guard Removal:

Remove the comb by pulling it towards yourself and then in an upward motion.

